

GTSE - RE+ EVENTS - PACIFIC NW

08/20/24 - 08/21/24

GREATER TACOMA CONVENTION & TRADE CENTER - EXHIBIT HALL A AND B - TACOMA, WA

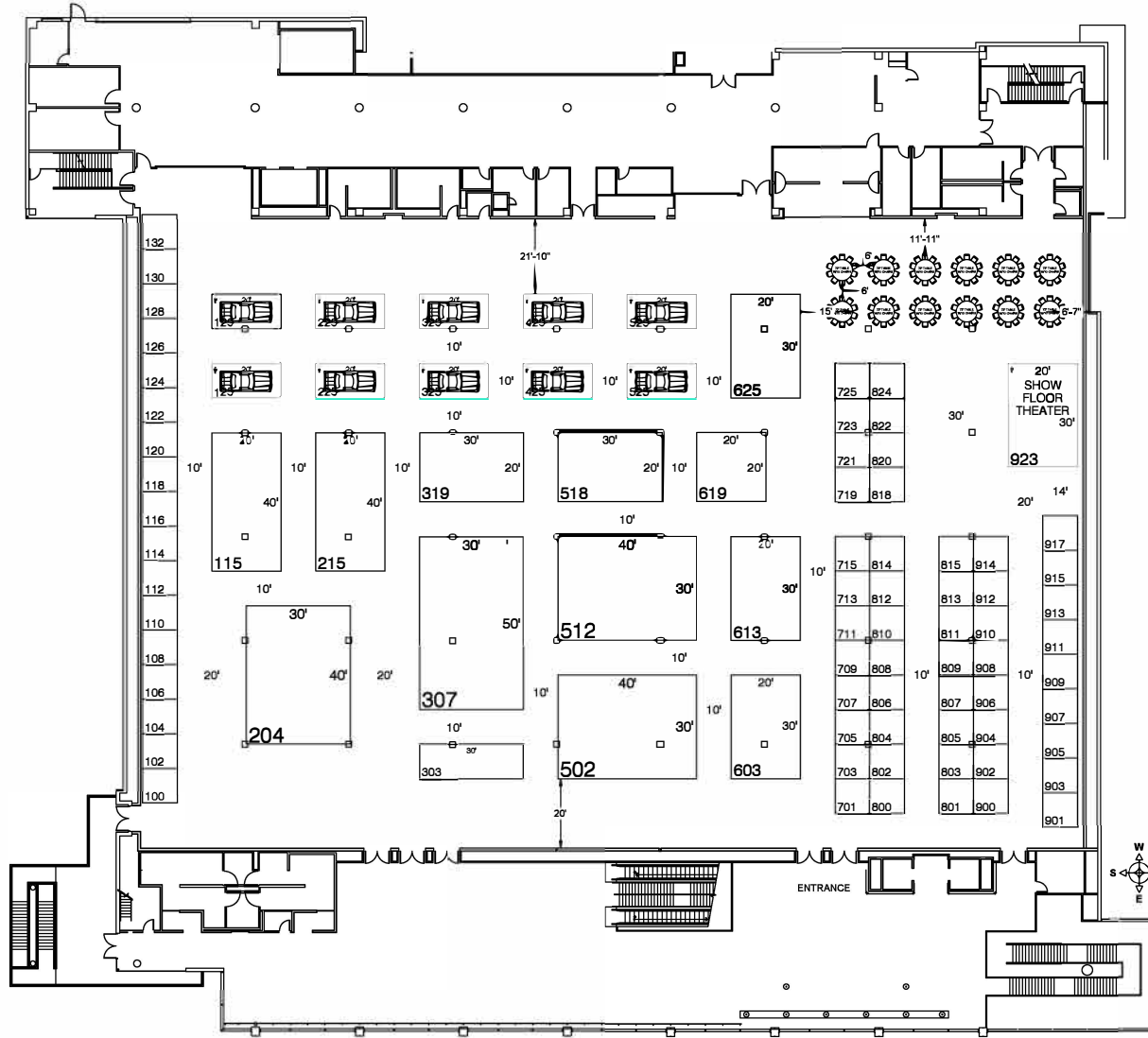

REVISION
Date: 3/4/2024
By: Wilfred Wallen

BOOTH COUNT

Booth #	Area	Area	Area	Area	Area
115	204	307	502	603	701-800
118	208	312	508	609	706-806
122	212	316	512	613	711-810
126	216	320	518	619	715-814
130	220	324	524	625	719-818
132	224	328	530	631	723-822
	228	332	536	637	727-826
	232	336	542	643	731-830
	236	340	548	649	735-834
	240	344	554	655	739-838
	244	348	560	661	743-842
	248	352	566	667	747-846
	252	356	572	673	751-850
	256	360	578	679	755-854
	260	364	584	685	759-858
	264	368	590	691	763-862
	268	372	596	697	767-866
	272	376	602	703	771-870
	276	380	608	709	775-874
	280	384	614	715	779-878
	284	388	620	721	783-882
	288	392	626	727	787-886
	292	396	632	733	791-890
	296	400	638	739	795-894
	300	404	644	745	799-898
	304	408	650	751	803-902
	308	412	656	757	807-906
	312	416	662	763	811-910
	316	420	668	769	815-914
	320	424	674	775	819-918
	324	428	680	781	823-922
	328	432	686	787	827-926
	332	436	692	793	831-930
	336	440	698	799	835-934
	340	444	704	805	839-938
	344	448	710	811	843-942
	348	452	716	817	847-946
	352	456	722	823	851-950
	356	460	728	829	855-954
	360	464	734	835	859-958
	364	468	740	841	863-962
	368	472	746	847	867-966
	372	476	752	853	871-970
	376	480	758	859	875-974
	380	484	764	865	879-978
	384	488	770	871	883-982
	388	492	776	877	887-986
	392	496	782	883	891-990
	396	500	788	889	895-994
	400	504	794	895	899-998
	404	510	800	901	903-999
	408	516	806	907	909-999
	412	522	812	913	915-999
	416	528	818	919	921-999
	420	534	824	925	927-999
	424	540	830	931	933-999
	428	546	836	937	939-999
	432	552	842	943	945-999
	436	558	848	949	951-999
	440	564	854	955	957-999
	444	570	860	961	963-999
	448	576	866	967	969-999
	452	582	872	973	975-999
	456	588	878	979	981-999
	460	594	884	985	987-999
	464	600	890	991	993-999
	468	606	896	997	999-999

BLDG. LEGEND:

DRAWING INFO

Passport Line Item Number:
#12302758
Facility:
GREATER TACOMA CONVENTION &
TRADE CENTER
Facility Location:
EXHIBIT HALL A
City & State:
TACOMA, WA
Scale: CUSTOM
Project #: —
Acct. Sales: TARA ALLEN
Acct. Mgmt: —
Started: 3/4/2024
Started By: WILFRED WALLEN
Prod. Branch: RENO

Freeman.

Disclaimer - This floor plan is preliminary and subject to change pending review and official approval by all authorities having jurisdiction. Every effort has been made to ensure the accuracy of all information contained on the floor plan. However, no warranties, either expressed or implied, are made with respect to this floor plan. If the location of building columns, utilities or other architectural components of the facility is a consideration in the construction or usage of an exhibit, it is the sole responsibility of the exhibitor to physically inspect the facility to verify all dimension and locations.
© Copyright 2024, Freeman Co. All rights reserved.

Confidential and Proprietary - The information contained herein is the proprietary information of Freeman and by accessing the information, the recipient agrees to keep the information confidential and not disclose it to any third party without the prior consent of Freeman. Recipient also agrees to only use the information for its internal evaluation purposes and for no other purpose, without the prior consent of Freeman.

File Path: C:\Users\jcaughlin\Documents\Freeman\Projects\RE+ Pacific NW\RE+MTC\2024\Exhibit A\Floor Plans\RE+MTC.dwg | Tab Name: 1:2302758.FP